

A Research on the Design and Structural Analysis of Industrial Building Construction

Dr. Krishna Nandan Prasad

Associate Professor, Katihar Engineering College, Katihar, Bihar

ARTICLE DETAILS

Article History

Published Online: 07 August 2018

Keywords

Design, Industrial Building, Structural Analysis, development, creativity, management, excellence.

ABSTRACT

The aim of this paper "A Research on the Design and Structural analysis of Industrial Building Construction" is to build up a Normal kind of industrial building with steel roof structures on open edges considering the economy of the structure which cultivates the innovativeness, designing skills, administration abilities and scholarly magnificence. - A multi storied Industrial building is chosen and is all around examined and designed. The examination and designing was finished by the standard determination to the conceivable broaden. The investigation of structure was finished utilizing the software package STAADPRO.V8i. All the structural components were planned physically. The specifying of support was done in AutoCAD 2013. The utilization of the software offers sparing in time It takes value on more secure side than manual work. The point of this paper is to design a mechanical building monetarily utilizing manual design techniques and computer aid design. The Project Report accentuates the structural analysis and design findings of industrial structure project.

1. Introduction

In the design of industrial buildings, load conditions and geometrical factors will direct the level of inconvenience and consequently the economy. The designer ought to have great information about the industrial process or reason for which the building is proposed. Along these lines, an ideal harmony amongst safety, function and economy can be accomplished. The fundamental measurements of an industrial building are generally decided from a blend of utilitarian and design considerations [1]. Its width is gotten first from a proprietor's investigation of the space required to do the preparing or storage operations. The designer at that point needs to consider whether this width can be given financially by a solitary clear traverse, or whether multi-inlet ranges are possible. In like manner the general length is normally promptly dictated by the proprietor; however the designer should offer idea to the ideal cove length. A portion of the components influencing the choice are:

- Foundation conditions and their ability to accept the column loads.
- Crane runway girder considerations
- Purlin and girt capacities
- Masonry bond dimensions.
- Tilt-up concrete panel size and available carnage.

2. Review of literature:

Typically the bayous in industrial buildings have frames spanning the width heading. A few such frames are masterminded at reasonable dispersing to get the required length. Contingent on the necessity, a few bayous might be developed abutting each other [2]. The decision of structural configuration relies on the traverse between the rows of columns, the headroom or freedom required the idea of roofing material and sort of lighting. In the event that traverse is less, portal frames, for example, steel bents or gable frames can be utilized yet in the event that traverse is vast then buildings with trusses are used [3].

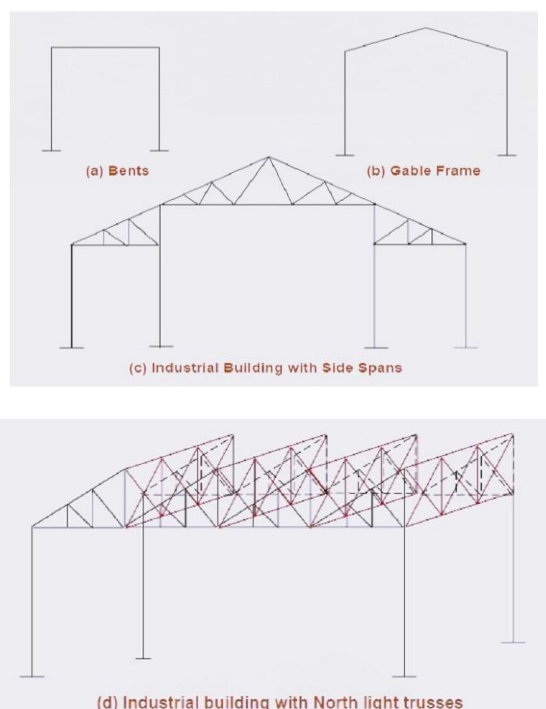

Fig. 1- Typical structural layout of an industrial

The horizontal and vertical bracings, utilized in single and multi-story buildings, are likewise trusses utilized fundamentally to oppose wind and different lateral loads. These bracings limit the differential avoidance between the diverse edges due to crane surge in industrial buildings [4]. They additionally give sidelong help to columns in small and tall buildings, hence expanding the buckling strength.

Floors: Different types of floor are required in any factory from their utilization thought, for example, production, workshop, stores, amenities, and organization. The administration condition will shift generally in these areas, so different floors sorts are required. Industrial floors should have adequate imperviousness to scraped spot, affect, corrosive activity and temperatures depending on the kind of movement completed. High strength and high-performance concretes can

satisfy most of these necessities monetarily and is the most widely recognized material used. Establishment for vibrating hardware, (for example, responding and fast turning apparatus) ought to be set upon rock or firm ground and it ought to be separated from nearby floor to avoid vibrations.

Roof System: While planning a roof, designer should search for following quality softness, strength, and water proof ness, and protection, imperviousness to fire, cost, durability and low maintenance charges. Sheeting, purlin and supporting roof trusses upheld on column provide common structural roof system for industrial buildings [5]. The sort of roof covering, its insulating value, acoustical properties, and the appearance from inward side, the weight and the maintenance are the various factors, which are given thought while designing the roof system. Brittle sheeting, for example, asbestos, creased and Trafford cement sheets or pliable sheeting, for example, stirred iron corrugated or profiled sheets are utilized as the roof covering material. The avoidance limits for purlins and truss rely upon the sort of sheeting. For weak sheeting small diversion esteems are endorsed in the code.

Lighting: Industrial operations can be carried on most proficiently when satisfactory enlightenment is given. The prerequisites of good lighting are its force and consistency. Since natural light is free, it is economical and savvy to utilize light most satisfactory for enlightenment in industrial plants at whatever point practicable [6]. Side windows are of much esteem in lighting the insides of small buildings yet they are very little compelling if there should arise an occurrence of large buildings. If there should arise an occurrence of large buildings screens are useful (Fig. 2.).

Ventilation: Ventilation of industrial buildings is additionally critical. Ventilations will be utilized for evacuation of heat, elimination of dust, used air and its substitution by clean fresh air. It should be possible by methods for regular strengths, for example, air circulation or by mechanical equipment such as fans. The large height of the roof might be utilized favorably by giving low-level bays and high-level outlets for air.

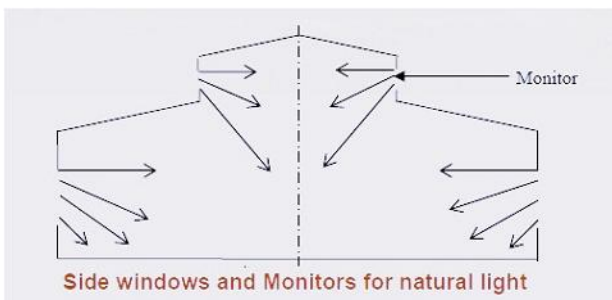

Fig.2- Side windows and Monitors for natural light

ROOF TRUSS: Steel trusses are ordinarily utilized as a part of commercial construction. They are pre-manufactured to arrange and are made in an open web design. They are basically pivotally loaded members which are more effective in opposing external loads since the cross-section is about uniformly stressed [7]. They are extensively used, particularly to traverse large gaps. Trusses are utilized as a part of roofs of single story industrial buildings, long span floors and roofs of multistory buildings, to oppose gravity loads.

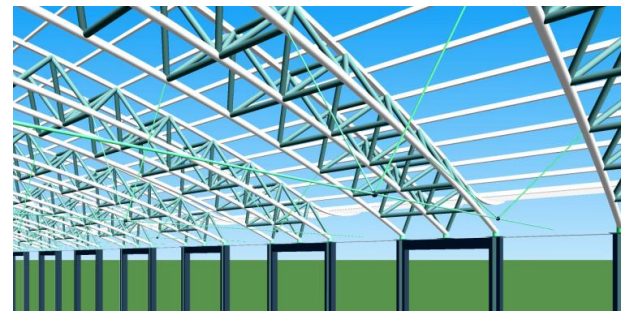

Fig.3- A 3D truss model showing internal components like arrangement of truss and connection between bays

The advantage of utilizing steel trusses for building is that they are more grounded than wood and more prominent open space inside a building is conceivable. They are perfect for barns, large storage buildings and commercial construction.

3. Loads on the roof truss:

Dead load: Generally the dead load on the roof trusses in single store industrial buildings consists of dead load of claddings and dead load of purlins, self-weight of the trusses notwithstanding the heaviness of bracings and so forth. Further, extra exceptional dead loads, for example, truss bolstered raise dead loads; extraordinary ducting and ventilator weight etc. could contribute to roof truss dead loads [8]. As the unmistakable traverse length (column free span length) expands, the self-weight existing apart from everything else opposing gable frames increments radically. In such cases roof trusses are more economical. Dead loads of floor slabs can be extensively diminished by receiving composite sections with profiled steel sheets.

Live load: The live load on roof trusses comprise of the gravitational load because of erection and overhauling and in addition dust load and so forth and the power is taken according to IS:875-1975. Extra extraordinary live loads, for example, snow loads in exceptionally cold climates, crane live loads in trusses supporting monorails may need to be considered.

Wind load: Wind load on the roof trusses, unless the roof slope is too high, would be typically inspire constrain opposite to the roof, because of suction impact of the wind blowing over the roof. Henceforth the wind load on roof truss generally acts inverse to the gravity load, and its extent can be bigger than gravity loads, causing inversion of strengths in truss members.

Earthquake load: Since earthquake load on a building depends on the mass of the building, earthquake loads more often than not don't oversee the design of light industrial steel buildings [9]. Wind stacks normally represent. In any case, on account of industrial buildings with an expansive mass situated at the roof or upper floors, the earthquake load may represent the design.

4. Representative Truss:

A representative truss of span 52m is selected and designed as per the requirement. The shape of the roof truss is chosen to be arc of a circle for two reasons:

- The economy of an arched truss lies in the fact that the principal compression members follow approximately the line of greatest strain, so that the bracing can be made very light.

- The effect of wind loads on the truss can be reduced if we use a parabolic arch over pitched truss with low elevation.

A picture of the building assumed is presented in the Fig.

4.

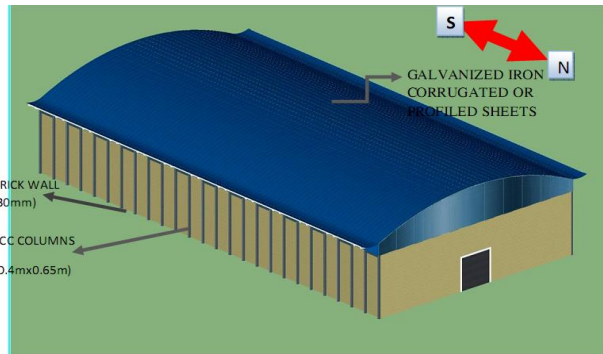

Fig 4- Representative Figure of the Building

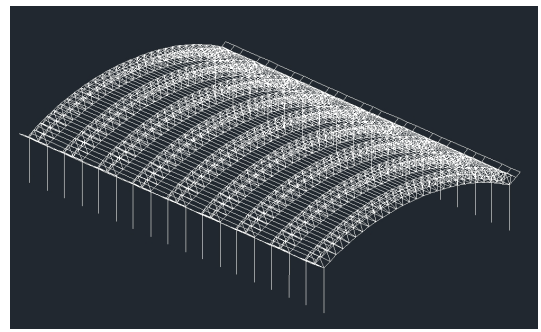

Fig. 6- 3D Elemental View of Entire Industrial Structure

Various components of the building: In the chosen representative building, various components are,

- Truss members
- Purlins
- Beams connecting the trusses to form bays.
- Galvanized iron corrugated or profiled sheets
- Columns made up of RCC.
- External walls of 30cm thick brick.

Computer model: A model was selected on the basis of requirements of the consumer. A three-dimensional structural space truss model of the building is developed using computer aided drafting software (AutoCAD). The .dxf file of the truss is imported into the Analysis and Designing software (STAAD Pro) and Geometry is prepared which is followed by Analysis and Design. The AutoCAD .dxf image files are shown in Fig. 5. And Fig. 6.

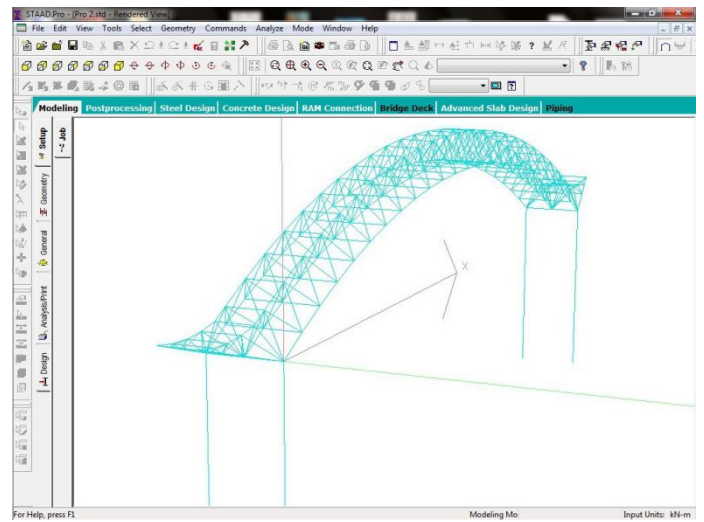

Fig 7- STAAD Import of .dxf file

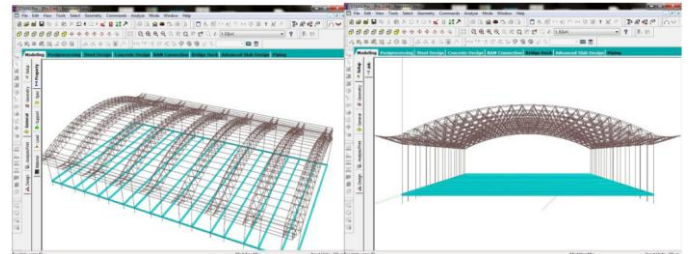

Fig. 8- Rendered Views after creating Geometry

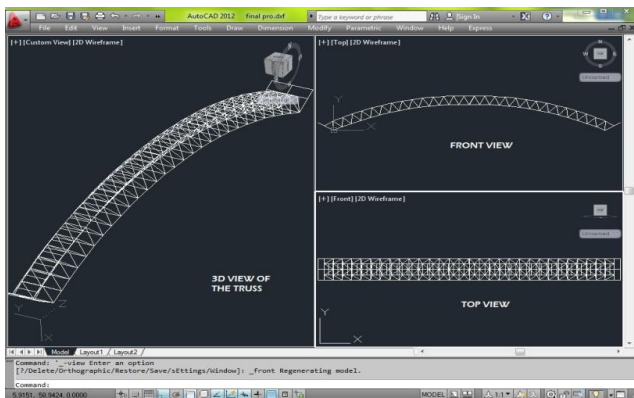

Fig. 5- Views of the Single Roof truss which is imported into STAAD Pro

Coordinate system: The structure has been aligned 00 to the True North. The principal axes in STAAD Pro are oriented as given below:

- The X global axis is towards east
- The Y global axis is pointing to upward.
- The Z global axis is towards north

Members: Members and nodes in the STAAD Pro model are identified with member numbers nodal numbers. Member groups are created for better accuracy while assigning properties and load.

5. Loads and combinations:

Structural loads or activities are powers, misshapeness or increasing velocities connected to a structure or its components. Loads cause stresses, deformations and displacements in structures. Assessment of their belongings is done by the methods of structural analysis. Excess load or over-burdening may cause structural failure, and thus such plausibility ought to be either considered in the design or strictly controlled [10]. Engineers often evaluate structural loads based upon published regulations, contracts, or details. Acknowledged technical standards are utilized for acknowledgment testing and inspection.

Building codes require that structures be designed and worked to securely oppose all activities that they are probably going to confront amid their service life, while staying fit for utilize. Minimum loads or activities are determined in these

building codes for sorts of structures, geographic locations, utilization and materials of construction. Structural loads are part into classifications by their starting reason. Obviously, as far as the actual load on a structure, there is no distinction between dead or live loading, but the split happens for use in safety calculations or simplicity of investigation on complex models as follows. To meet the prerequisite that design strength be higher than maximum loads, Building codes endorse that, for structural design, loads are expanded by load factors [11]. These variables are, approximately, a proportion of the theoretical design quality to the maximum load expected in benefit. They are created to help accomplish the desired level of unwavering quality of a structure based on probabilistic studies that consider the heap's originating cause, recurrence, distribution, and static or dynamic nature.

Types of loads:

Dead loads: The dead load includes loads that are generally consistent after some time, including the heaviness of the structure itself, and resolute apparatuses such as walls, plasterboard or cover. Dead loads are otherwise called Permanent loads. The designer can likewise be moderately certain of the size of dead loads as they are firmly connected to thickness and amount of the construction materials. These have a low variance, and the designer himself is regularly in charge of the details of these components.

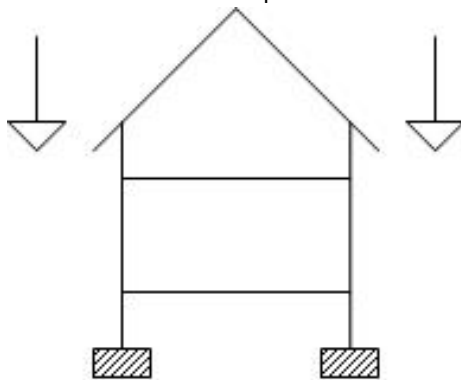

Fig.9- Direction of Dead load

Calculation of Dead loads is done as follows:

Dead load of component= unit weight of the component x volume of the component

Live loads: Live loads are the aftereffect of the inhabitation of a structure. As it were, it shifts with how the building is to be utilized. For example, a storage space is significantly more liable to bigger loads than is a residential bedroom. Cheap seats at a stadium are probably going to see larger loads than what is seen on a pitched building roof.

The specified live loads are for the most part communicated either as consistently circulated area loads or point loads connected over small areas.

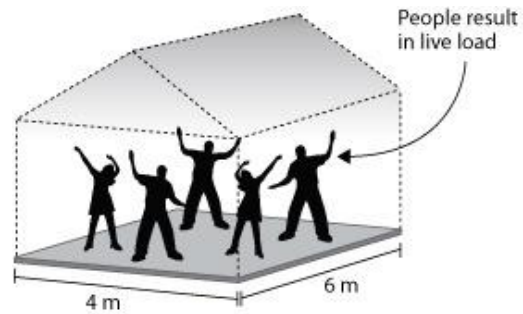

Fig.10- live load in a building

Concentrated loads: Certain occupancies, such as office space, have the potential for a larger concentrated load (such as a large copy machine) being located in a space. This space may also be designed for uniformly distributed loads, but it is not probable that both the uniformly distributed load and the large concentrated load will occupy the space at the same time.

Consequently the space must be designed to accommodate, separately, the uniformly distributed load and the point load, with the point load being moved around the space so as to cause maximum effect on the supporting elements.

A concentrated load shall be applied as follows:

- (a) At its known position or where its position is not known, in the position giving the most adverse effect.
- (b) Distributed over the actual area of application or if the actual area is not known.

Wind loads on roofs: The pressure normal to the slope of the roof is obtained by multiplying the basic pressure p by the factors given in Table 1. The table also shows the effect of internal pressure produced due to the permeability of the cladding or opening in walls and roof. If the wind blows parallel to the ridge of the roof, the average external wind pressure of the roof may be taken as -0.6p on both slopes of the roof over a length from the gable end equal to the mean height of the roof above the surrounding ground level and as -0.4p over the remaining length of the roof on both slopes.

Table. 1- Wind loads on roofs

Wind pressure on roofs (Wind normal to eaves) Sums of external and internal pressure											
Roof of building	Zero Permeability			Normal Permeability				Large openings			
	External Pressure			$p_i = +0.2p$		$p_i = -0.2p$		$p_i = +0.5p$		$p_i = -0.5p$	
	Windward	Leeward		Windward	Leeward	Windward	Leeward	Windward	Leeward	Windward	Leeward
1	2	3	4	5	6	7	8	9	10	11	
0	-1.00	-0.50	-1.2	-0.70	-0.8	-0.30	-1.5	-1.00	-0.5	0.00	
10	-0.70	-0.50	-0.9	-0.70	-0.5	-0.30	-1.2	-1.00	-0.2	0.00	
20	-0.40	-0.50	-0.6	-0.70	-0.2	-0.30	-0.9	-1.00	+0.1	0.00	
30	-0.10	-0.50	-0.3	-0.70	+0.1	-0.30	-0.6	-1.00	+0.4	0.00	
40	+0.10	-0.50	-0.1	-0.70	+0.3	-0.30	-0.4	-1.00	+0.6	0.00	
50	+0.30	-0.50	+0.1	-0.70	+0.5	-0.30	-0.2	-1.00	+0.8	0.00	
60	+0.40	-0.50	+0.2	-0.70	+0.6	-0.30	-0.1	-1.00	+0.9	0.00	
70	+0.50	-0.50	+0.3	-0.70	+0.7	-0.30	0	-1.00	+1.00	0.00	
80	+0.50	-0.50	+0.3	-0.70	+0.7	-0.30	0	-1.00	+1.00	0.00	
90	+0.50	-0.50	+0.3	-0.70	+0.7	-0.30	0	-1.00	+1.00	0.00	

In the multiplane roofs with spans, heights and slopes nearly equal, the windward truss gives shelter to the other trusses. For general stability calculations and for the design columns, the windward slope of wind-ward span and leeward slope of leeward span are subjected to the full normal pressure of suction as given in table. 1. And on all other roof slopes, only wind drag is considered (see Fig. 11).

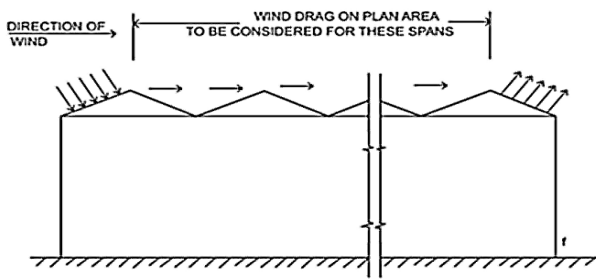

Fig. 11- Wind drag

For the design of roof trusses, however, full normal pressure or suction is considered on both faces, presuming that there was only one span. The wind pressures given above are the average pressures on a roof slope. For designing the roof sheeting or the fastenings of roof sheeting, we may take a larger wind pressure because these pressures may considerably exceed the average value on small areas. For designing roof sheeting and its fastenings, the values given in Table 1 may be increased numerically by 0.3p. In a distance equal to 15% of the length of the roof from the gable ends, fastenings should be capable of resisting a section of 2.0p on the area of the roof sheeting them support.

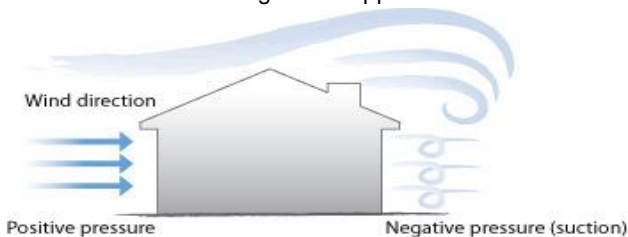

Fig. 12- Effect of wind on building

The wind loads are calculated using IS: 875(part3) as

$$\text{Wind Pressure} = 0.6 \times V_z^2$$

Where V_z = Design wind speed

$$V_z = k_1 k_2 k_3 V_b$$

k_1 = probability factor

k_2 = Terrain and height factor

k_3 = Topography factor

Seismic loads: Single storey industrial buildings are usually governed by wind loads rather than earthquake loads. This is because their roofs and walls are light in weight and often pitched or sloping and also because the buildings are permeable to wind which results in uplift of the roof. However, it is always safe to check any building for both wind and earthquakes. Earthquake loading is different from wind loading in several respects and so earthquake design is also quite different from design for wind and other gravity loads. Severe earthquakes impose very high loads and so the usual practice is to ensure elastic behaviour under moderate earthquake and provide ductility to cater for severe earthquakes. Steel is inherently ductile and so only the calculation of loads due to moderate earthquake is considered. This can be done as per the IS 1893 code. For industries using hazardous materials and fragile products the importance factor may be taken as 1.5 but for most industries it may be taken as 1.0. The Response reduction factor R may be taken as 4 for buildings where special detailing as per section 12 of IS 800 has not been followed.

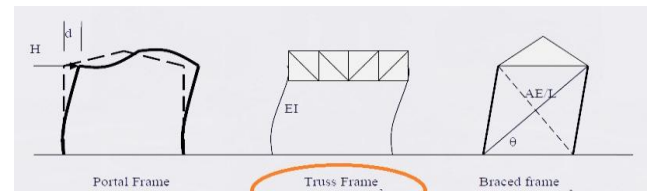

Fig. 13- Lateral Stiffness for various configurations

The natural time period T is very important and should be calculated correctly. For single storey structures, it may be taken as $T = 2\pi\sqrt{(k/m)}$ where k is the lateral (horizontal) stiffness of the supporting structure and m is the mass of the roof usually taken as the sum of the roof dead load plus 50% of the live load divided by the acceleration due to gravity g. Guidelines for calculating k in some simple cases are given in Fig. 13.

Finally, the acceleration ratio Sa/g can be obtained from the graph corresponding to the soil type as shown in Fig. 14. In this figure, medium soil corresponds to stiff clay or sand and soft soil corresponds to loose clay and loamy soils.

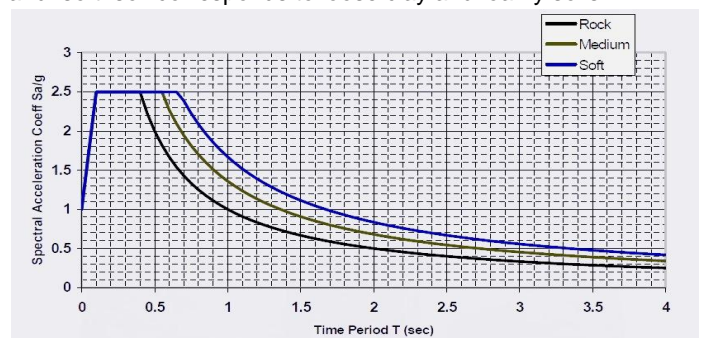

Fig. 14- Response Spectrum for 5% damping

6. Conclusion:

The aim of this paper, "to various rooms by applying them for all intents and purposes by examination and design of a curved roof truss, for the use of industrial storage of materials, effectively to achieve the requirement also as economy", has been fulfilled successfully. The different operations of the building have been broke down splendidly and the local codes have been taken after accurately. The broke down truss has quality to withstand various loads. The manual designs of other components are additionally given high importance and a computation of desired reinforcement is found with high factors of safety. We recommend that this building has satisfactory quality to oppose all the loads and meet its motivation of capacity of materials in its life expectancy. STAAD analysis comes about demonstrate that the structure can oppose various loads making advances on it. The industrial training, taken through a time of one month permitted having plentiful introduction to different field hones in the investigation and design of multi storied buildings and furthermore in different construction techniques utilized as a part of the industry. All the structural components were designed manually and point by point utilizing AutoCAD 2013. The investigation and design was finished by standard determinations to the possible extend.

References

1. Unnikrishna Pillai, S. and Devadas Menon, Reinforced Concrete Design, Tata McGraw-Hill Publishing Company Limited, New Delhi, 2003
2. Al Nageim, H., Durka, F., Morgan, W. & Williams, D.T. 2010. Structural mechanics: loads, analysis, materials and design of structural elements. 7th edition. London, Pearson Education.
3. Prasad, I.B. 2000. A text book of strength of materials. 20th edition. 2B, Nath Market, NaiSarak, Delhi, Khanna Publishers.
4. IS: 875 (Part 1)-1987, Indian Standard Code of Practice for Design Loads (Other than earthquake) for Building and Structures, Bureau of Indian Standards, New Delhi.
5. IS: 875 (Part 2)-1987, Indian Standard Code of Practice for Design Loads (Other than earthquake) for Building and Structures, Bureau of Indian Standards, New Delhi.
6. IS: 875 (Part 3)-1987, Indian Standard Code of Practice for Design Loads (Other than earthquake) for Building and Structures, Bureau of Indian Standards, New Delhi.
7. IS: 1893 (Part 1) 2002- Indian Standard Criteria for earthquake resistant design of structures, Bureau of Indian Standards, New Delhi.
8. IS: 13920:1993, Ductile detailing of reinforced concrete structures subjected to seismic forces, Bureau of Indian Standards, New Delhi.
9. IS 456:2000, Indian standard Plain and reinforced concrete – Code of Practice, Bureau of Indian standard, 2000, New Delhi.
10. SP 16: 1980, Design Aids for Reinforced Concrete to IS: 456-1978, Bureau of Indian Standards, New Delhi.
11. Roy, S.K. & Chakrabarty, S. 2009. Fundamentals of structural analysis with computer analysis and applications. Ram Nagar, New Delhi, S. Chand and Co. Ltd.